

MYLEK®

MY40160SR

Electric Stand Fan

with Remote Control



BEFORE USE:

Please read the instructions carefully. You must inspect the appliance including its cable and plug for any signs of damage. If the product is damaged, **DO NOT USE** and contact your supplier immediately for refund or replacement.

www.hsdonline.co.uk

Introduction

General Information

Please read the entire instruction manual before using the product and then save it for future reference. We reserve the right for any errors in text or images and any necessary changes made to technical data. If you have any questions concerning technical problems please contact our Customer Services on 0800 091 3171.

Safety Instructions

Please read this instruction manual carefully before use and keep in a safe place for future reference. If you give the appliance to another person supply them with this instruction manual.



Intended use

This appliance is intended for use as a cooling fan. Use it for domestic purposes and in the way indicated in this instruction manual.

This appliance can be used by children aged from 8 years and above and persons with reduced physical, sensory or mental capabilities or lack of experience and knowledge if they have been given supervision or instruction concerning use of the appliance in a safe way and understand the hazards involved.

Children shall not play with the appliance.

Cleaning and user maintenance shall not be made by children without supervision.

IMPORTANT SAFETY INFORMATION

- Make sure the mains supply voltage is the same as that on the maker's plate.
- Do not plug the appliance in until it has been fully and correctly assembled.
- Never insert fingers, pencils or any other object through the grille when fan is running.
- Be sure fan is on a stable, even surface when operating to avoid overturning.
- Do not keep or use this appliance near bath, shower or swimming pool.
- Never immerse the appliance in water or any other liquid.
- Only use the appliance in dry environments, never in damp places such as bathrooms, etc.
- Do not handle the appliance with wet hands.
- Do not use the appliance with the power cable wound up.
- Keep the fan away from objects which may enter the grilles, such as curtain cords, plants, etc.
- Do not place the fan near flames, cookers or heaters.
- Keep a check on the appliance when in use, especially when children are nearby.
- Unplug at the mains when not in use.
- Never pull on the power cable when unplugging.
- Make sure the appliance has been unplugged before cleaning.
- Do not use the fan with a damaged power cable or plug, or if it is not working properly.
- Repairs and power cable replacement must only be carried out by Authorised Technical Service staff.
- This appliance must be installed following the national regulations for electrical installations.
- **WARNING:** In order to ensure your children's safety, please keep all packaging (plastic bags, boxes, polystyrene etc). out of their reach.
- These instructions for use belong to the appliance and must be kept in a safe place. If changing owners, these instructions must be passed to the new owner!

Safe positioning

- Do not place the fan on unstable surfaces.
- For your own safety and that of others: water and electricity are a dangerous combination! Do not use this fan in a bathroom or near a swimming pool. Ensure that the appliance cannot fall into water (bath wash basin, shower cubicle, etc).

Instructions

Parts description

- ① Front Guard
- ② Blade Securing Cap
- ③ Blade
- ④ Rear Guard Securing Nut
- ⑤ Rear Guard
- ⑥ Motor housing
- ⑦ Control Switch
- ⑧ Front Housing
- ⑨ Rear Housing & Securing Bolt
- ⑩ Inner Pipe
- ⑪ Height Adjuster
- ⑫ Outer pipe
- ⑬ Top Base
- ⑭ Securing Bolt and Washer
- ⑮ Weighted Bottom Base

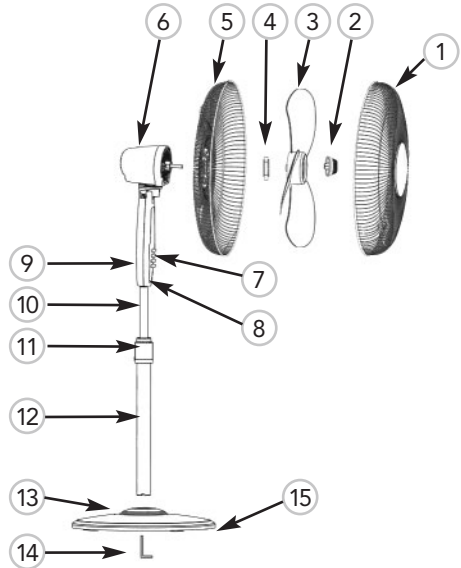

Technical Specification

Model: MY40160SR

Rated Voltage: 230V AC

Power: 45W

Remote Control:

This remote control takes
2 x AAA batteries
(Not Supplied)

Batteries should not be mixed with general household waste. For proper recycling, please take these products to a designated collection point where they will be accepted free of charge or return them to your local retailer. Please contact your local authority or your household waste disposal service for further details of your nearest designated collection point.



Assembly

ASSEMBLING THE BASE AND COLUMNS

1. Place **Top Base (13)** over **Fan Weighted Base (15)**.
2. Align and place **outer pipe (12)** into the top of **top base (13)** and secure into place from the bottom with the bolt and washer (15)
3. Attach the **Rear Housing (9)** to the **Inner Pipe (10)** and secure with the bolt located at the bottom rear of the **Rear Housing** section.

IDENTIFICATION OF THE FAN PARTS

- 1 Motor housing
- 2 Rear Guard Handle
- 3 Rear Guard Securing Nut
- 4 Blade
- 5 Blade Securing Cap
- 6 Front Guard
- 7 Bolt and Nut

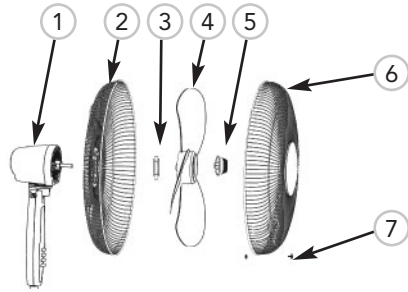

FAN ASSEMBLY

1. Make sure the **Rear Guard Handle** is facing to the top and mount the **Rear Guard (2)** to the **Motor Housing (1)** and secure it with the **Locking Nut (3)**.
2. Insert the **Blade (4)** onto the **Motor Shaft** and tighten the blade with the **Blade Cap (5)**
3. Hold the **Front Guard (6)** to the **Rear Guard (2)** and make sure the two holes align at the bottom of each guard.
4. Place the bolt and nut (7) through the holds at the bottom of each guard and tighten.
5. Push the securing clips into place around the circumstance of the **Front Guard (6)** securely in place over the **Rear Guard (2)**.

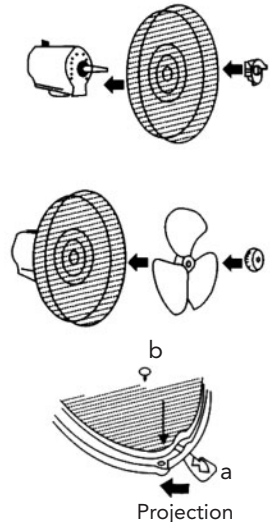

CAUTION: NEVER OPERATE THE FAN WITH A DAMAGED BLADE.

NOTE: You must check all parts and assemble the fan correctly and check before plugging in and switching on.

Operating instructions

MANUAL OPERATION

1. Press the "ON/SP" button to switch the fan on. Press again this button to choose between 3 speeds **Low**, **Medium** or **High**, your chosen setting will display on the screen.
2. Press the "OFF" button to switch the fan off.
3. Press the "SWING" button once for the fan to oscillate and press again to switch off oscillation.
4. Press the "TIMER" to choose between countdown operating times of 1-7 hours, the unit will switch off when your chosen countdown time has elapsed, your chosen setting will display on the screen.

REMOTE CONTROL OPERATION

1. Press the "ON/SP" button to switch the fan on. Press again this button to choose between 3 speeds **Low**, **Medium** or **High**, your chosen setting will display on the screen.
2. Press the "OFF" button to switch the fan off.
3. Press the "SWING" button once for the fan to oscillate and press again to switch off oscillation.
4. Press the "TIMER" to choose between countdown operating times of 1-7 hours, the unit will switch off when your chosen countdown time has elapsed, your chosen setting will display on the screen.
5. Press the "MODE" button to choose between **Normal**, **Natural** or **Sleep** function. These options are only available via the remote control and your chosen option will display on the screen. If no option is chosen the unit will operate in the **Normal** fan mode.

Normal Speed: The fan will operate in your selected speed between **Low/Medium** or **High** until you turn it off manually or your set time has elapsed.

Natural Speed: Fan will alternate between fan speeds intermittently switching on and off continuously.

Sleep Speed: The fan will operate at your chosen speed, then intermittently switch off and back on again, dropping down a speed approximately every 30 mins until it reaches the lowest speed.



Storage

- Keep the original box in which the fan was packed to store it during the cooler months when it is not in use.

Cleaning & Maintenance

We recommend that you clean your fan at least twice a year to remove accumulated dust and dirt.

1. Switch off the fan and unplug from the power outlet.
2. Plastic parts should be cleaned with damp cloth or sponge.
3. Thoroughly dry the fan with a clean dry cloth.
4. Do not use scouring pads, abrasive and hard detergents.
5. Do not immerse the motor unit in any liquid.
6. Store fan in a clean dry place when not in use.
7. Make sure the fan is completely dry before plugging into any power outlet and switching on.

No other user maintenance is required or recommended.

- DO NOT immerse the fan in water and never allow water to drip into motor housing.

CAUTION: DO NOT ALLOW WATER TO RUN INTO THE FAN AS THIS COULD CREATE A FIRE OR ELECTRIC SHOCK HAZARD.

Environmental Responsibilities



Meaning of crossed-out wheeled dustbin:

Do not dispose of electrical appliances as unsorted municipal waste, use separate collection facilities.

Contact your local council for information regarding the collection systems available.

If electrical appliances are disposed of in landfills or dumps, hazardous substances can leak into the groundwater and get into the food chain damaging your health and well-being.

When replacing old appliances with new ones, the retailer is legally obligated to take back your old appliance for disposal free of charge.

Batteries should not be mixed with general household waste. For proper recycling, please take these products to a designated collection point where they will be accepted free of charge or return them to your local retailer. Please contact your local authority or your household waste disposal service for further details of your nearest designated collection point.

PAT Testing

When used in a workplace, this product must be safety-tested yearly by a qualified electrician (PAT Tested) in order to comply with the Electricity at Work Regulations. We recommend that it is PAT tested regularly when used in a domestic environment.

SERVICE WARRANTY

Hygiene Supplies Direct guarantees the product free from defects in materials and workmanship for a period of 1 year from date of purchase.

Should this unit be operated under conditions other than those recommended, at voltages other than the voltage indicated on the unit, or any attempts made to service or modify the unit, then the warranty will be rendered void. The product you buy may sometimes differ slightly from illustrations. This warranty is in addition to, and does not affect, your statutory rights.

If you have any problems with this product, please call our Help Desk on **0800 091 3171** or email sales@hygienesuppliesdirect.com

YESSS Electrical, Normanton, WF6 1TN declares that the Mylek Electrical Stand Fan is exclusively manufactured and imported for Hygiene Supplies Direct Ltd.